

Quick Start Guide

Smart Wi-Fi Light Switch

Wire Your Switch

- 1 **Turn off** the circuit breaker. Check whether your power is off by turning your switch on and off a few times.

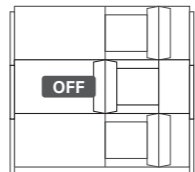

CAUTION!



1. **Risk of Electric Shock** - The product should be installed by a qualified electrician.
2. **High Voltage** - Disconnect power supply at the circuit breaker before servicing.
3. Use copper conductors only.

- 2 Remove the wallplate of the old switch and label the wires.

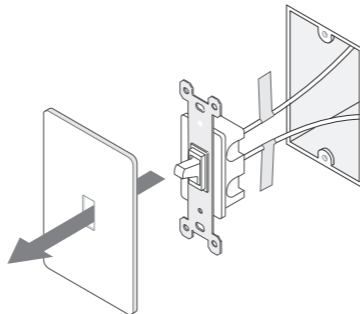

Ground: Usually green or copper.
Neutral: Usually white, not connected to the dumb switch.
Line/Load: Usually black, and connected to the dumb switch.
 If you are unsure, consult a qualified electrician.

- 3 Disconnect wires from the old switch.

- 4 Connect the wires to the smart switch as shown below.

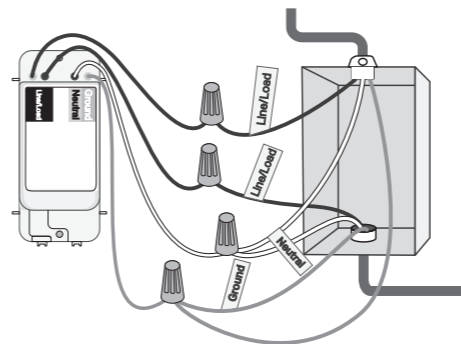

Note: No need to distinguish between Line and Load wires.

- 5 Line up the switch with the mounting holes. Secure it with screws.

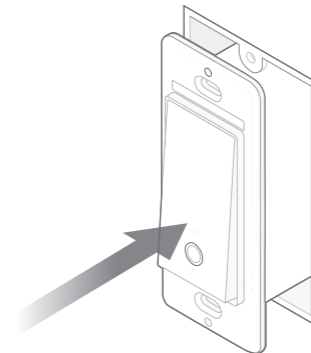

- 6 Attach the wallplate and turn on the circuit breaker. Then the wiring is finished.

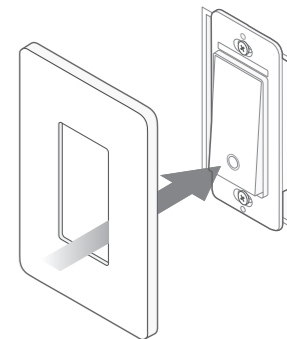

Set Up Your Switch

STEP 1 DOWNLOAD APP

Get the **Tapo** app from the App Store or Google Play.



STEP 2 SET UP

Tap the **+** button in the app. Select **Switches** and then your model. Follow the step-by-step app instructions to set up your smart switch.

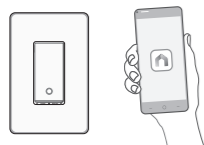

Third-Party Services

Tapo works with Alexa, Google Assistant, and other third-party services to control your switch by voice. Go to **Me > Third-Party Services** in the Tapo app to integrate third-party services.

For step-by-step setup instructions, please visit:

- **Google Home Assistant:**
<https://www.tp-link.com/support/faq/1534/>
- **Amazon Alexa:**
<https://www.tp-link.com/support/faq/944/>

Specifications

Rating: 100-120 V~ 50/60 Hz

Load: 15 A General Use

600 W Max Incandescent, 1/6HP Motor

Operation temperature: 0~40°C

Method of mounting included: Independently

mounted (Vertically position only);

Operating control, Type 1.C action

Pollution Degree 2, Rated Impulse Voltage 2500V

Software Class A, NEMA Type 1

Recommended Load Types:

LED: ≤ 100W Ceiling Fan: ≤ 120 W

Appearance

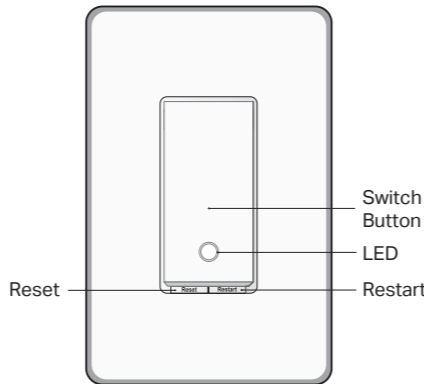

Button Explanations

Reset	Press and hold for about 5s to reset Wi-Fi while keeping other settings. Press and hold for about 10s to restore factory default settings.
Restart	Press to restart your switch.

LED Status

Solid amber	Starting up; disconnected from cloud.
Blinking amber & green	Ready for setup.
Blinking green	Connecting to Wi-Fi.
Stay green for 30s	Connected to Wi-Fi.
Solid red	Disconnected from Wi-Fi.
Blinking amber	Device resetting.
White	Light fixture is off.
Blinking green slowly	Firmware upgrading.

CAUTION

High Voltage-Disconnect power supply at the circuit breaker before servicing

MISE EN GARDE

Haute tension : débranchez l'alimentation électrique au niveau du disjoncteur avant l'utiliser

Safety Notice

Before installing, servicing or removing the switch, read and follow all safety precautions including the following:

- **CAUTION – Risk of Electric Shock –** More than one disconnect switch may be required to de-energize the equipment before servicing. A circuit breaker which disconnects the Line and Neutral conductor simultaneously is suitable. Ensure power is off at the circuit breaker before removing or installing any switch. Use a non-contact voltage tester to ensure the power is off.
- The Smart Switch must be installed and used in accordance with the National Electric Code (NEC) or your local electrical code. If you are unfamiliar with these codes and requirements, or are uncomfortable performing the installation, consult a qualified electrician.
- Do not install the Smart Switch with wet hands or when standing on wet or damp surfaces.
- Install only in a suitable UL Listed outlet box (suitable dimensions:
H > 2.95 in./75 mm, W > 1.81 in./46 mm, D > 2 in./51 mm).



Need some help?

Visit www.tapo.com/support/ for technical support, user guides, FAQs, warranty and more information.